

**PKW is a functional personnel module with a office, WC, a dining room with small kitchen**

**PRODUCT SPECIFICATION:**

Building area	24,3 m <sup>2</sup>
Total area, of which	21,0 m <sup>2</sup>
- Office	9,0 m <sup>2</sup>
- Corridor	3,5 m <sup>2</sup>
- WC	1,0 m <sup>2</sup>
- Kitchen/Dining	7,5 m <sup>2</sup>
Transportation measures	2950 x 8570 x 3000 mm
Inside Measures	2620 x 8120 x 2400 mm
Weight	ca´ 5400 kg
Roof angle	1:60

**INCLUDING:**

- C01 - Galvanized steel profile frame, liftable with forklift and crane
- F05 - Dining table for 4 persons
- F20 - Chair customer/dining
- F36 - Clothes hanger hook 1 pc on wall
- F40 - Minikitchen set, incl.; fridge, stove, sink and mixer
- F50 - Cabinet over Minikitchen
- F52 - Cabinet with Shelf beside Minikitchen
- F82 - Microwave oven
- F90 - Mirror on wall
- E50 - Timer socket 0-120 min
- P50 - Ceramic basin with mixer
- P70 - Toilet seat and toilet paper roll holder
- H30 - Water heater 10 L

**AVAILABLE AS ADD ON PRODUCTS:**

- CEWB - Long side wall opening element B (filling element)
- CEWC1 - Long side wall opening element C1 (without door leaf)
- CEWC2 - Long side wall opening element C2 (with ext. door leaf)
- CEWC3 - Long side wall opening element C3 (with int. door leaf)
- CEWC4 - Long side wall opening element C4 (with remov. fill. elem.)
- S22 - Locking bar for external door
- S25 - SmartLock for doors
- S05 - Window grid 1200x1200 mm
- S18 - Venetian blind 1200x1200 mm
- H50 - Heat Pump/Air Conditioning (Air-Air)
- V35 - Wall fan OUT-100/IN-100 with heat recovery
- E10 - Electrical connection cable 32A when campus building
- External connections when campus building
- Internal connections when campus building

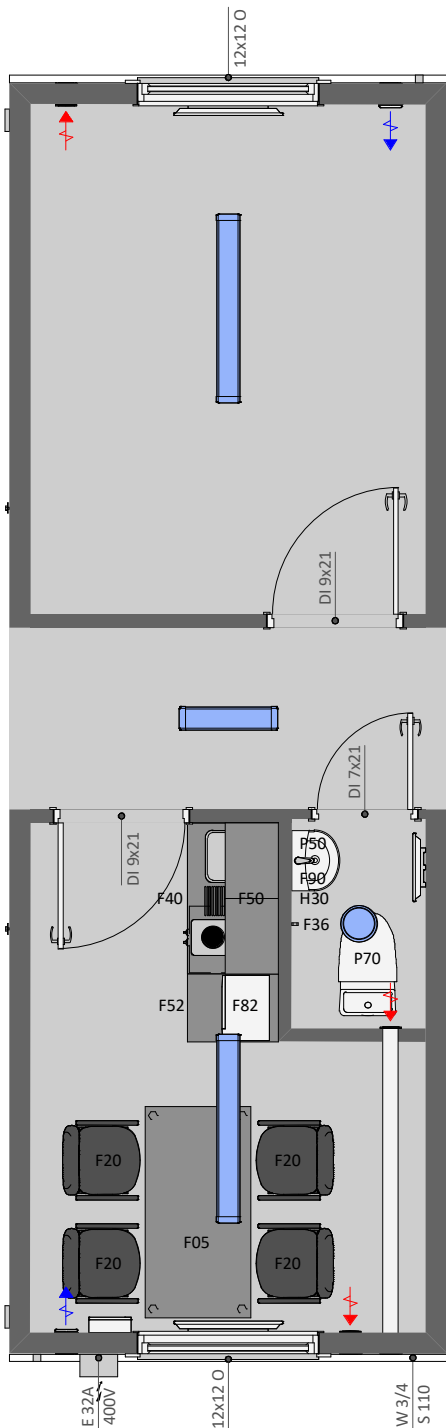

Reseller:



Containerpoolen i Sverige AB  
<https://containerpoolen.se>